

## PERFORATED CONE TYPE STRAINERS

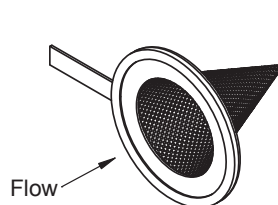

Wire cloth on inside perforated support

Wire Mesh is available Inside or Outside upon request. Please Specify Flow Direction.

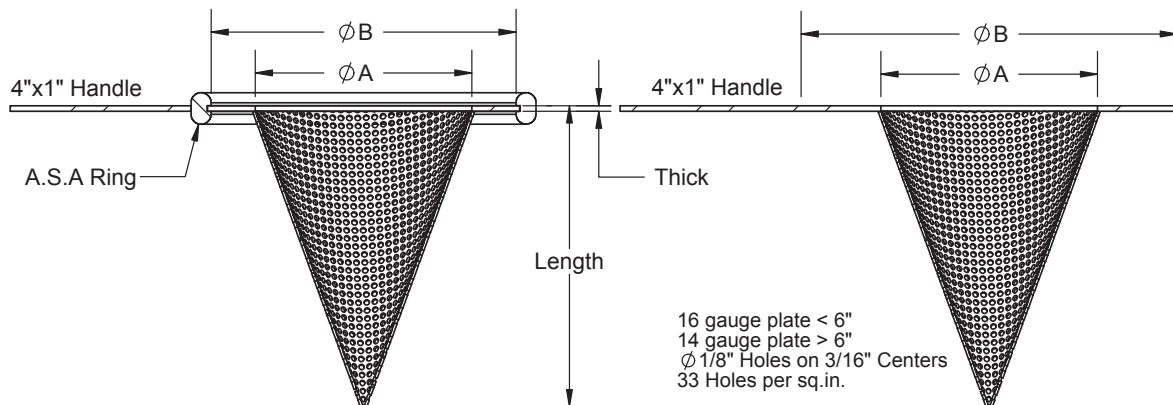
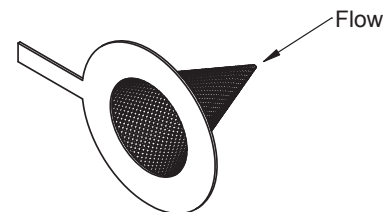

Wire cloth on outside perforated support

PIPE SIZE	"A" DIM.	RING NUMBER	"B" DIA.				RTJ 300 600	LENGTH			THICK		APPROX. WT. lbs
			RF & FF			100%		150%	200%	RF	RTJ		
			150	300	600								
3/4	5/8	R13	2 1/4	2 1/2	2 1/2	1 3/8	1 1/2	2 1/2	3	IIGA	IIGA	1/2	
1	7/8	R16	2 1/2	2 1/2	2 1/2	1 11/16	2	2 1/2	3 1/2	"	"	1/2	
1 1/4	1	R18	2 3/4	3	3	2 1/16	2 1/2	3 1/2	4 1/2	"	"	1/2	
1 1/2	1 3/8	R20	3 1/4	3 1/2	3 1/2	2 3/8	2 1/2	3 1/2	5	"	"	1/2	
2	1 3/4	R23	4	4 1/4	4 1/4	2 13/16	3	4 1/2	6	"	"	1/2	
2 1/2	2 1/4	R26	4 3/4	5	5	3 9/16	3 1/2	5	7	"	"	1	
3	2 3/4	R31	5 1/4	5 3/4	5 3/4	4 7/16	4	6	8 1/2	"	"	1	
3 1/2	3 1/4	R34	6 1/4	6 1/4	6 1/4	4 3/4	4 1/2	7	9 1/2	"	"	1 1/2	
4	3 3/4	R37	6 3/4	7	7 1/2	5 7/16	5 1/2	8	11	"	"	1 1/2	
5	4 3/4	R41	7 1/2	8 1/4	9 1/4	6 11/16	6 1/2	10	13 1/2	"	"	2	
6	5 5/8	R45	8 1/2	9 3/4	10 1/4	7 7/8	7 1/2	12	16	"	"	2 1/2	
8	7 1/2	R49	10 3/4	12	12 1/2	10 3/16	10	15 1/2	21	"	"	3 1/2	
10	9 3/8	R53	13 1/4	14	15 1/2	12 5/16	12 1/2	19 1/2	26 1/2	"	"	4 1/2	
12	11 5/8	R57	16	16 1/2	17 3/4	14 9/16	15	23	31	"	"	6	
14	12 7/8	R61	17 1/2	19	19 1/4	16 1/16	16	25 1/2	34	"	"	10	
16	14 7/8	R65	20	21	22	18 1/16	18 1/2	29	39	"	"	20	
18	16 7/8	R69	21 1/2	23 1/4	24	20 9/16	21	32 1/2	44	"	"	30	
20	18 7/8	R73	23 3/4	25 1/2	26 3/4	22 1/2	23	36	49	"	"	40	
24	22 7/8	R77	28	30 1/4	31	26 5/8	27 1/2	43 1/2	58 1/2	"	"	55	
30	28 1/2	R95	34 1/4	37 1/4	37 3/4	33	35 1/2	55 1/2	74 1/2	"	"	70	
36	34 1/2	R98	40 3/4	43 1/2	44	39 3/8	42	66	89 1/2	"	"	90	

## BASKET TYPE STRAINERS

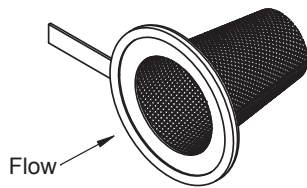
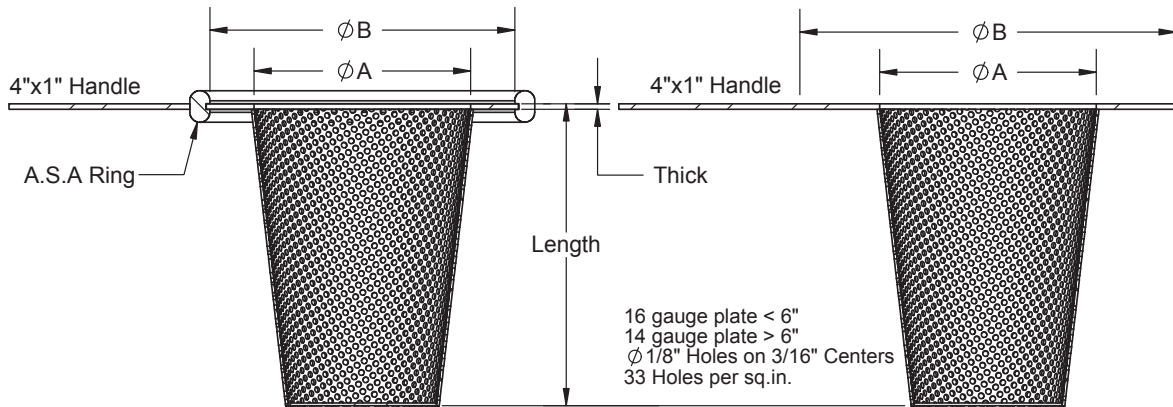

Wire cloth on inside perforated support

Wire Mesh is available Inside or Outside upon request. Please Specify Flow Direction.



Wire cloth on outside perforated support

PIPE SIZE	"A" DIM.	"C" DIM.	RING NUMBER	"B" DIA.				LENGTH (% OPEN AREA)			THICK		APPROX. WT. lbs
				RF & FF			RTJ 300 600	100%	150%	200%	RF	RTJ	
				150	300	600							
3/4	5/8	3/8	R13	2 1/4	2 1/2	2 1/2	1 3/8	1	1 1/2	1 1/2	IIGA	IIGA	1/2
1	7/8	1/2	R16	2 1/2	2 1/2	2 1/2	1 11/16	1	1 1/2	2	"	"	1/2
1 1/4	1	3/4	R18	2 3/4	3	3	2 1/16	1	2	2 1/2	"	"	1/2
1 1/2	1 3/8	3/4	R20	3 1/4	3 1/2	3 1/2	2 3/8	1 1/2	2	3	"	"	1/2
2	1 3/4	1 1/4	R23	4	4 1/4	4 1/4	2 13/16	1 1/2	2 1/2	3 1/2	"	"	1/2
2 1/2	2 1/4	1 1/2	R26	4 3/4	5	5	3 9/16	2	3 1/2	4 1/2	"	"	1/2
3	2 3/4	2	R31	5 1/4	5 3/4	5 3/4	4 7/16	3	4 1/2	5 1/2	"	"	1/2
3 1/2	3 1/4	2 1/4	R34	6 1/4	6 1/4	6 1/4	4 3/4	3	4 1/2	5 1/2	"	"	1
4	3 3/4	2 1/2	R37	6 3/4	7	7 1/2	5 7/16	3	4 1/2	6	"	IIGA	1
5	4 3/4	3 1/4	R41	7 1/2	8 1/4	9 1/4	6 11/16	3 1/2	5 1/2	7 1/2	"	"	1 1/2
6	5 5/8	4	R45	8 1/2	9 3/4	10 1/4	7 7/8	4	6 1/2	9	"	"	2
8	7 1/2	5 1/2	R49	10 3/4	12	12 1/2	10 3/16	5	8	11	"	"	4
10	9 3/8	7 1/4	R53	13 1/4	14	15 1/2	12 5/16	6	10	14	"	"	6
12	11 5/8	8 3/4	R57	16	16 1/2	17 3/4	14 9/16	7 1/2	12	16 1/2	"	"	8
14	12 7/8	10	R61	17 1/2	19	19 1/4	16 1/16	7 1/2	12 1/2	17 1/2	IIGA	"	10
16	14 7/8	11 3/4	R65	20	21	22	18 1/16	9	14 1/2	20 1/2	"	"	12
18	16 7/8	13 1/2	R69	21 1/2	23 1/4	24	20 9/16	10 1/2	17	23 1/2	"	"	16
20	18 7/8	15	R73	23 3/4	25 1/2	26 3/4	22 1/2	11	18 1/2	25 1/2	"	"	20
24	22 7/8	18	R77	28	30 1/4	31	26 5/8	13 1/2	22 1/2	31	"	"	30
30	28 1/2	20	R95	34 1/4	37 1/4	37 3/4	33	15 1/2	26	36 1/2	"	"	40
36	34 1/2	26	R98	40 3/4	43 1/2	44	39 3/8	18 1/2	31	43 1/2	"	"	50

## TEE TYPE STRAINERS

PIPE SIZE	DIMENSIONS IN INCHES					
	150 # RATING			300 # RATING		
	A	B	C	A	B	C
2	5	10	5	5	10 1/2	5 1/4
2 1/2	6	11 1/2	5 3/4	6	12	6
3	6 3/4	12 1/4	6 1/8	6 3/4	13	6 1/2
4	8 1/4	14 1/4	7 1/8	8 1/4	15	7 1/2
5	9 3/4	16 3/4	8 3/8	9 3/4	17 1/2	8 3/4
6	11 1/4	18 1/4	9 1/8	11 1/4	19	9 1/2
8	14	22	11	14	22 3/4	11 3/8
10	17	25	12 1/2	17	26 1/4	13 1/8
12	20	29	14 1/2	20	30 1/4	15 1/8
14	22	32	16	22	33 1/4	16 5/8
16	24	34	17	24	35 1/2	17 3/4
18	27	38	19	27	39 1/2	19 3/4
20	30	41 3/8	20 11/16	30	42 3/4	21 3/8
24	34	46	23	34	47 1/4	23 5/8

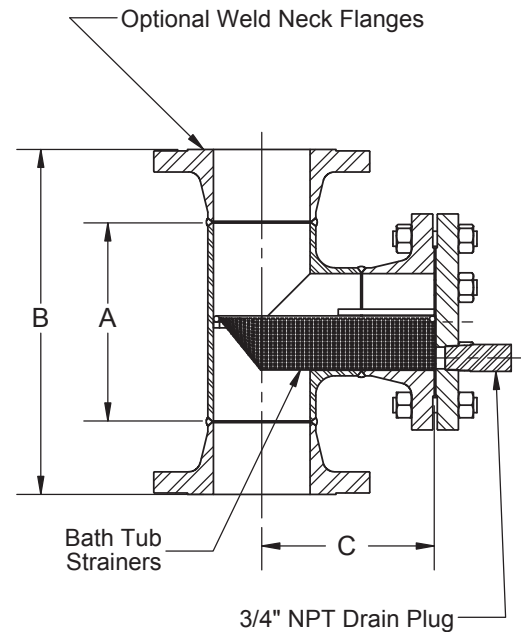

## BATH TUB TYPE STRAINERS

PIPE SIZE	SCH.	DIMENSIONS IN INCHES					
		150 # RATING			300 # RATING		
		A	B	C	A	B	C
2	40	1 15/16	1 1/4	6	1 15/16	1 1/4	6 1/4
	80	1 13/16	1 3/16	5 15/16	1 13/16	1 3/16	6 3/16
	160	1 9/16	1 1/16	5 13/16	1 9/16	1 1/16	6 1/16
2 1/2	40	2 5/16	1 7/16	6 15/16	2 5/16	1 7/16	7 3/16
	80	2 3/16	1 3/8	6 7/8	2 3/16	1 3/8	7 1/8
	160	2	1 5/16	6 13/16	2	1 5/16	7 1/16
3	40	2 15/16	1 3/4	7 5/8	2 15/16	1 3/4	8
	80	2 3/4	1 11/16	7 9/16	2 3/4	1 11/16	7 15/16
	160	2 1/2	1 9/16	7 7/16	2 1/2	1 9/16	7 15/16
4	40	3 7/8	2 1/4	9 1/8	3 7/8	2 1/4	9 1/2
	80	3 11/16	2 1/8	9	3 11/16	2 1/8	9 3/8
	160	3 5/16	1 15/16	8 13/16	3 5/16	1 15/16	9 3/16
6	40	5 15/16	3 3/8	12 1/8	5 15/16	3 3/8	12 1/2
	80	5 5/8	3 1/4	12	5 5/8	3 1/4	12 3/8
	160	5 5/16	2 15/16	11 11/16	5 1/16	2 15/16	12 1/16
8	40	7 13/16	4 5/16	15	7 13/16	4 5/16	15 5/16
	80	7 1/2	4 3/16	14 13/16	7 1/2	4 3/16	15 3/16
	160	6 11/16	3 3/4	14 3/8	6 11/16	3 3/4	14 3/4
10	40	9 7/8	5 3/8	17 1/2	9 7/8	5 3/8	18 1/8
	80	9 7/16	8 1/8	17 1/4	9 7/16	5 1/8	17 7/8
	160	8 3/8	4 5/8	16 3/4	8 3/8	4 5/8	17 3/8
12	40	11 7/8	6 3/8	20 1/2	11 7/8	6 3/8	21 1/8
	80	11 5/8	6 1/16	20 3/16	11 5/8	6 1/4	21
	160	10	5 7/16	19 9/16	10	5 7/16	20 3/16

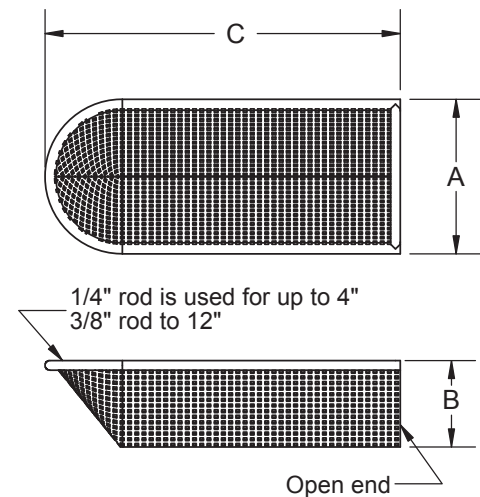

## PERMANENT STRAINERS

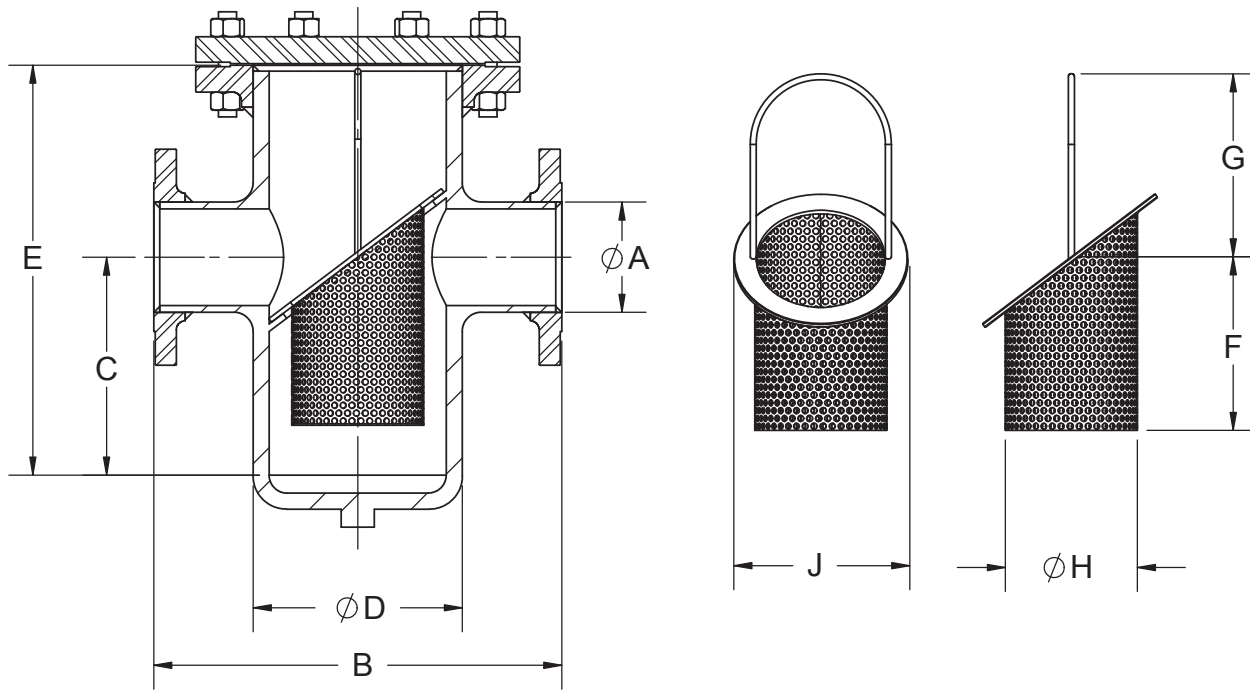

DIMENSIONS IN INCHES

PIPE SIZE	150									300								
	A	B	C	D	E	F	G	H	J	A	B	C	D	E	F	G	H	J
2	2 3/8	15	7	4 1/2	15	5	8 1/8	2 1/4	3 1/2	2 3/8	17	7	4 1/2	15 1/2	5	8 5/8	2 1/4	3 1/2
3	3 1/2	18	7	6 5/8	15	5	8 1/8	3 3/4	5 1/2	3 1/2	20	7	6 5/8	15 1/2	5	8 5/8	3 3/4	5 1/2
4	4 1/2	22	9	8 5/8	17	7	8 1/8	5 1/2	7 1/4	4 1/2	24	9	8 5/8	17 1/2	7	8 5/8	5 1/2	7 1/4
6	6 5/8	24	12	10 3/4	22	10	10 1/8	7 1/2	9 1/4	6 5/8	27	12	10 3/4	22 3/4	10	10 7/8	7 1/2	9 1/4
8	8 5/8	28	13	12 3/4	24	11	11 1/8	9 1/4	11 1/4	8 5/8	31	13	12 3/4	24 3/4	11	11 7/8	9 1/4	11 1/4
10	10 3/4	34	14	16	26	12	12 1/8	12 1/4	14 1/2	10 3/4	37	14	16	26 3/4	12	12 7/8	12 1/4	14 1/2
12	12 3/4	36	16	18	29	13 1/2	13 1/8	13	16 1/2	12 3/4	40	16	18	29 3/4	13 1/2	13 7/8	13	16 1/2
14	14	39	17	20	31	14 1/2	14 1/8	15 1/4	18 1/2	14	43	17	20	31 3/4	14 1/2	14 7/8	15 1/4	18 1/2
16	16	44	19	24	34	16	15 1/8	18 1/4	22 1/2	16	49	19	24	34 3/4	16	15 7/8	18 1/4	22 1/2
18	18	44	19	24	34	16	15 1/8	18 1/4	22 1/2	18	49	19	24	34 3/4	16	15 7/8	18 1/4	22 1/2
20	20	44	21	24	38	18	17 1/8	18 1/4	22 1/2	20	49	21	24	38 3/4	18	17 7/8	18 1/4	22 1/2
24	24	49	22	30	40	19	18 1/8	22	28	24	50	22	30	41	19	19 1/8	22	28
30	30	59	26	36	48	23	22 1/8	30 1/4	34 1/4	30	60	26	36	49	23	23 1/8	30 1/4	34 1/4
36	36	69	30	42	56	26	26 1/8	35 1/2	39 3/4	36	69	30	42	57	26	27 1/8	35 1/2	39 3/4
42	42	72	34	48	62	30	28 1/8	41 1/2	45 3/4	42	72	34	48	63	30	29 1/8	41 1/2	45 3/4

# FLAT STRAINERS

This style is primarily for applications where the flanges cannot be separated sufficiently to install a basket or conical strainer. Caution: The flow area of the pipe is generally reduced by at least fifty percent resulting in significant line losses and rapid clogging. Wire mesh overlay may be added for finer particle retention.

## Series FP For Mating to Raised Face Flanges

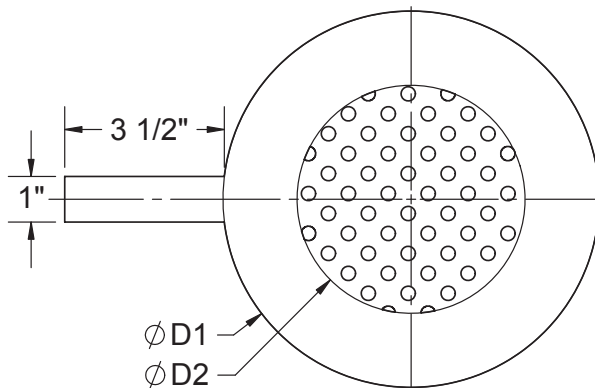

T = Flange Thickness

## Series F-RJ For Mating to Ring Joint Flanges

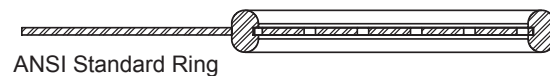
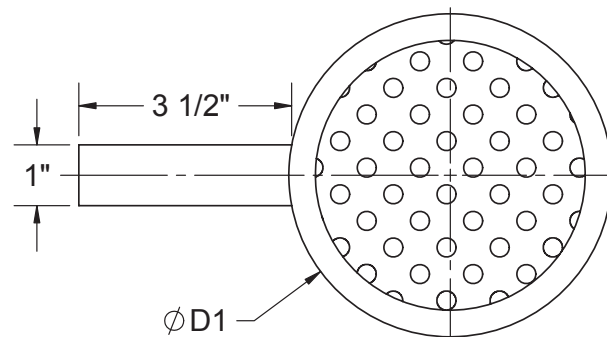

ANSI Standard Ring

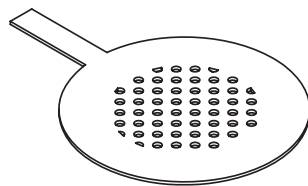

Standard perforation is  $\phi 5/16$ " holes on  $7/16$ " staggered centers  
Other perforations are available on request.

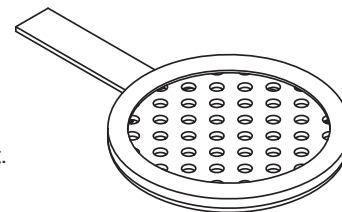

## RAISED FACE

STYLE	PIPE	150 lb.			300 lb.		
		D1	D2	T	D1	D2	T
FP	3/4	2 1/8	3/4	11ga	2 1/2	3/4	11ga
FP	1	2 1/2	1	11ga	2 3/4	1	11ga
FP	1 1/4	2 3/4	1 1/4	11ga	3	1 1/4	11ga
FP	1 1/2	3 1/8	1 1/2	11ga	3 1/2	1 1/2	11ga
FP	2	3 7/8	2	11ga	4 1/8	2	11ga
FP	2 1/2	4 5/8	2 1/2	11ga	4 7/8	2 1/2	11ga
FP	3	5 1/8	3	11ga	5 5/8	3	11ga
FP	3 1/2	6 1/8	3 1/2	11ga	6 1/8	3 1/2	11ga
FP	4	6 5/8	4	11ga	6 7/8	4	11ga
FP	5	7 1/2	5	11ga	8 1/4	5	11ga
FP	6	8 1/2	6	11ga	9 5/8	6	11ga
FP	8	10 3/4	8	11ga	11 7/8	8	11ga
FP	10	16 3/8	10	11ga	14	10	11ga
FP	12	15 7/8	12	11ga	16 3/8	12	11ga
FP	14	17 1/2	13 1/4	11ga	18 7/8	13 1/4	11ga
FP	16	20	15 1/4	11ga	21	15 1/4	11ga
FP	18	21 3/8	17	11ga	23 1/4	17	11ga
FP	20	23 5/8	19	11ga	25 1/2	19	11ga
FP	24	28	23	11ga	30 1/4	23	11ga
FP	30	34 1/4	29	3/16	37 1/8	29	3/16
FP	36	40 3/4	35	3/16	43 1/2	35	3/16

## RING JOINT

STYLE	300 & 600 lb.		900 lb.	
	D1	T	D1	T
FRJ	1 3/8	11ga	1 7/16	11ga
FRJ	1 11/16	11ga	1 11/16	11ga
FRJ	2 1/16	11ga	2 1/16	11ga
FRJ	2 3/8	11ga	2 3/8	11ga
FRJ	2 13/16	11ga	3 5/16	11ga
FRJ	3 9/16	11ga	3 13/16	11ga
FRJ	4 7/16	11ga	4 7/16	11ga
FRJ	4 3/4	11ga	4 3/4	11ga
FRJ	5 7/16	11ga	5 7/16	11ga
FRJ	6 11/16	11ga	6 11/16	11ga
FRJ	7 7/8	11ga	7 7/8	11ga
FRJ	10 3/16	11ga	10 3/16	11ga
FRJ	12 5/16	11ga	12 5/16	11ga
FRJ	14 9/16	11ga	14 9/16	11ga
FRJ	16 1/16	11ga	15 7/8	11ga
FRJ	18 1/16	11ga	17 7/8	11ga
FRJ	20 9/16	11ga	20 1/4	11ga
FRJ	22 1/2	11ga	22 1/4	11ga
FRJ	26 5/8	11ga	26 1/4	11ga
FRJ	33	11ga	32 1/2	11ga
FRJ	39 3/8	11ga	38 7/8	11ga